

# PEX PLUMBING SYSTEM

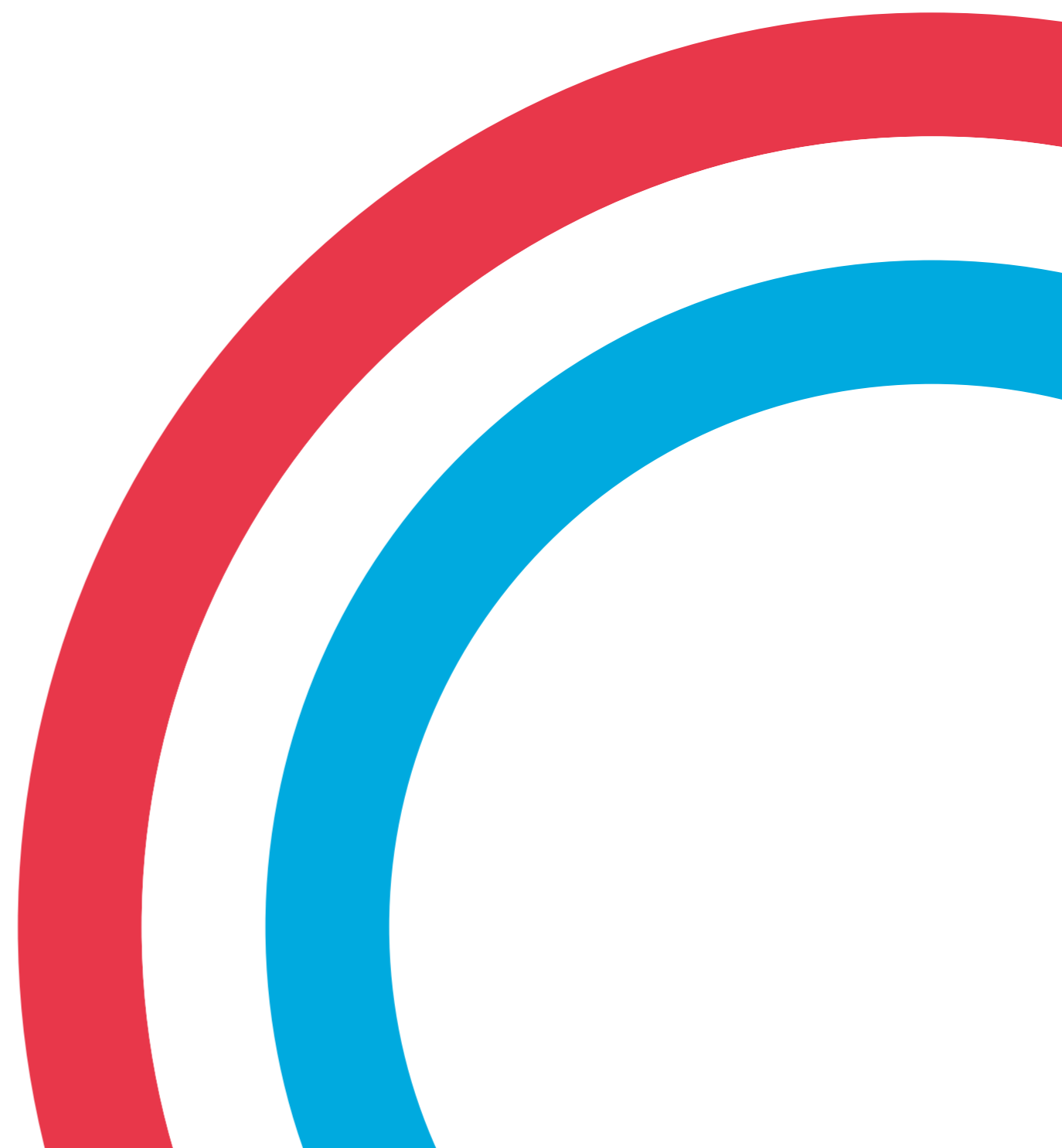

Revised on June 15, 2023

# CATALOGUE INDEX

---

03

---

ABOUT RIIFO

05

---

INNOVATION

05

---

SCALE

- 05 Facility
- 05 Capacity

06

---

RIIFO APPROVALS

- 06 Group Honor
- 06 Piping Systems

07

---

PROJECT REFERENCE

13

---

PEX PLUMBING SYSTEM

- 14 Pex Plumbing System
- 15 Lead Free Crimp Fittings
- 16 Press Fittings

17

---

TECHNICAL DATA

17

---

SPECIFICATIONS

- 18 PEX Pipes
- 18 PEX Press Fitting
- 27 Manifolds
- 28 Tools&Accessories

29

---

INSTALLATION

- 30 PEX+Lead Free Crimp Fittings  
(Copper crimp ring)
- 31 PEX+Lead Free Crimp Fittings  
(Stainless steel crimp)
- 33 PEX+Press Fitting



## ABOUT RIIFO

RIIFO is a leading multinational corporation, providing one-stop piping solutions applied in residential, commercial, agricultural, industrial, and infrastructural sectors. Persistently reinventing since 1996, with over 8,000 employees, 70 branches & subsidiaries, and 300,000 distributors, we have served customers in more than 100 countries and regions.

With an integrated value chain, from R&D to manufacturing and retail distribution, we strive to fulfill our mission of offering ideal piping products and services for all environments.

**8,000**

Employees

**300,000**

Distributors worldwide

**70**

Serving over 100 countries & regions

**100+**

Branches & Subsidiaries



## INNOVATION

Believing that innovation is the key to go beyond the ordinary, RIIFO has founded world-class labs recognised and certified by CNAS. Over 600 innovation talents are sparing no effort to challenge industrial boundaries, achieving 923 patents and 20 technology awards.

And this innovative passion has been perfectly presented on high quality products and outstanding services, and we strive to offer ideal piping solutions to everyone.

## SCALE

We adopt highly automated production lines with the most rigorous and comprehensive production control, and management system to handle such a powerful production.

### Facility

**9**  
global production bases

**5,200+**  
production staffs

**200**  
hectares area  
totally

**4,000+**  
automated  
production lines

### Capacity

#### Production Capacity

- Pipe: **3.2 billion** m/yr
- Fitting: **1.3 billion** pcs/yr

#### Storage Capacity

- **1,735,000 m<sup>3</sup>** ≈ 61,950 TEU (20 GP Containers)



## RIIFO APPROVALS

RIIFO adheres to the concept of quality priority, and all RIIFO products are produced under rigorous quality control with excelsior manufacturing. Until now, RIIFO has gained over 50 certificates, such as NSF, DVGW, AENOR, WRAS Watermark, etc. These certificates worldwide underline our technical and quality know-how, and we can provide you with 25-year system warranty backed up by an international insurance company.

### Company Accreditations

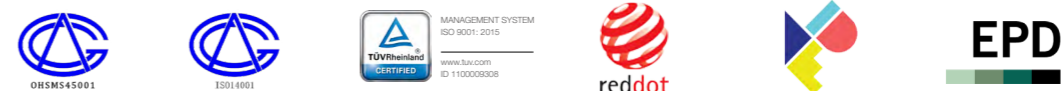

### Piping Systems



# PROJECT REFERENCE

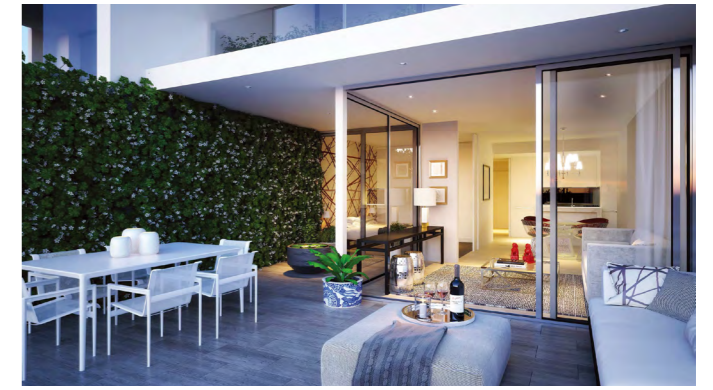

## Sydney, Australia

Project: Diamond Apartments  
Type: Residential  
Year: 2018  
Product: Pex Plumbing System

The Diamond Apartments are a luxury development, by Rommark Corporation, in the heart of Bondi Junction. The development includes a mix of 67 apartments and 6 retail spaces.

Each of the apartments comes with a spectacular outdoor balcony and living space. Apartments on the upper levels also come with view out over the city - its a choice of the brilliant city lights or a view of the Sydney harbour.

## Brisbane, Australia

Project: Aria Valencia Ap Artmnts  
Type: Residential  
Year: 2017  
Product: Pex Plumbing System

The Aria Valencia is a 12-storey development featuring 125 luxury apartments with views of the Brisbane River at Kangaroo Point.



# PROJECT REFERENCE

## Century Addis Real Estate, Ethiopia

Project: Century Addis Real Estate-Brass Apartment Project  
 Type: Apartment  
 Year: 2021  
 Product: PVC System



## MDM, Ethiopia

Project: BOLE-RWANDA District Grand View Addis Project  
 Type: Apartment  
 Year: 2021  
 Product: PVC System+Multilayer Plumbing System

## CSCEC, Ethiopia

Project: CSCEC Ethiopia National Stadium  
 Type: Stadium  
 Year: 2021  
 Product: HDPE Water supply pipe+HDPE Double wall corrugated pipe

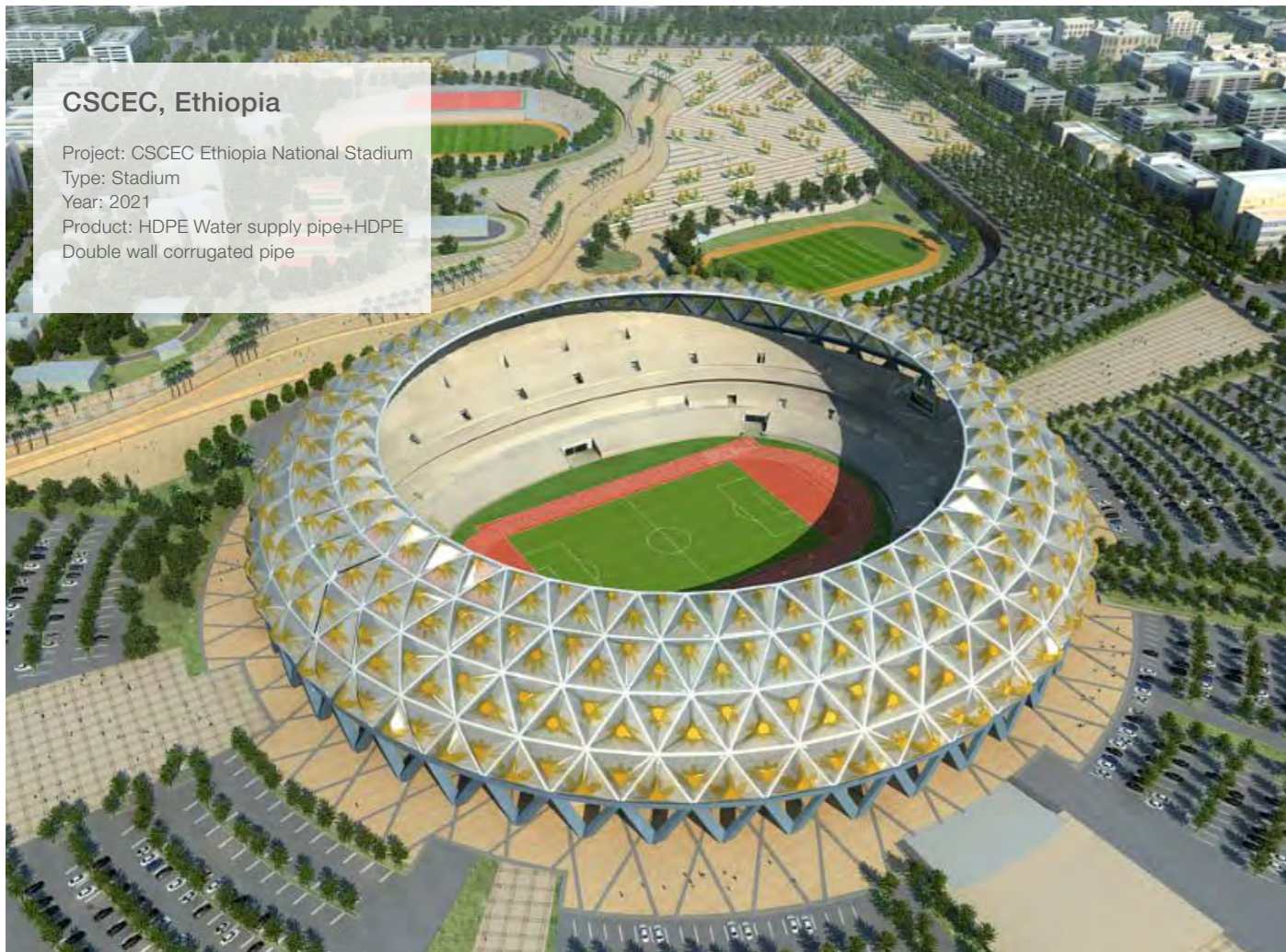

## Kidus Commercial Center, Ethiopia

Project: Kidus Commercial Center  
 Type: Apartment  
 Year: 2021  
 Product: PVC System

# PROJECT REFERENCE

## Nakhonsawon, Thailand

Project: 42C Hotel  
Type: Hotels  
Year: 2019  
Product: PPR Plumbing System



## Bali, Indonesia

Project: FOX HARRIS Jimbaran Beach  
Type: Hotels  
Year: 2016  
Product: PPR Plumbing System



## Samui Island, Thailand

Project: Sofitel So Samui  
Type: Hotels  
Year: 2019  
Product: PPR Plumbing System



## Semarang, Indonesia

Project: Hotel Chanti  
Type: Hotels  
Year: 2017  
Product: PPR Plumbing System



## Chon Buri, Thailand

Project: The Hill Pattaya  
Type: Hotels  
Year: 2019  
Product: PPR Plumbing System





## PEX PLUMBING SYSTEM

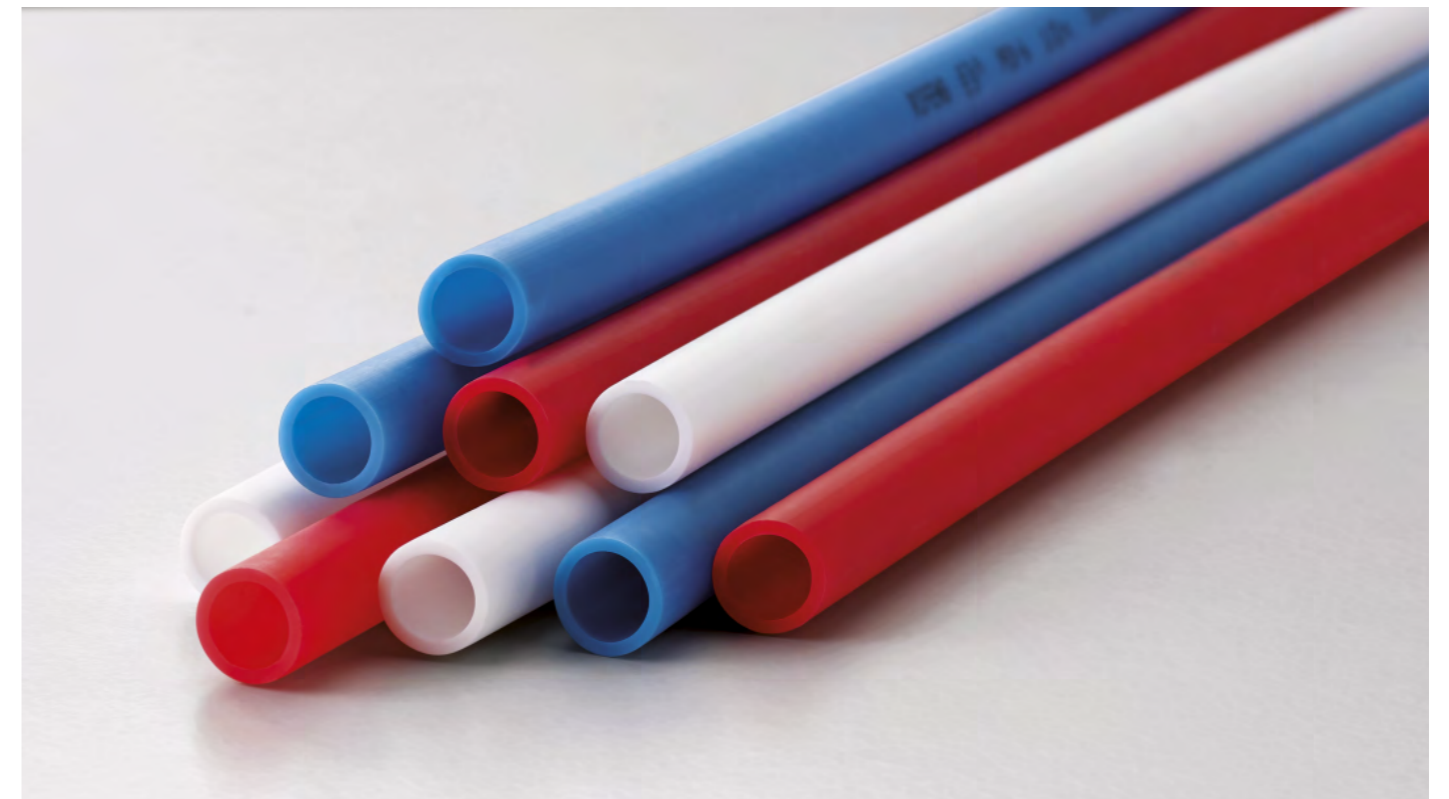

## PEX Plumbing System

RIIFO PEX Plumbing system consists of PEX-b pipes, lead free crimp fittings, press fittings and corresponding accessories. It is popular with customers for its chlorine resistance, frost resistance and flexibility, and is widely used in the residential, commercial and industrial applications.

RIIFO PEX-b pipe is made of cross-linked polyethylene. RIIFO utilizes the production method of silane cross-linking that provides PEX-b pipe with superior chemical and mechanical performance. RIIFO PEX-b pipe is available in red, white and blue, and ideal for supply of potable water.

### Advantages



Ultra-flexible and fewer fittings needed



Keep stable without cracking even in freezing days



Super temperature and pressure resistance (180°F 100psi)



Extraordinary chemical stability and excellent resistance to oxidation & corrosion



Hygienic and healthy



Durable for 50 years



Highest level of chlorine resistance (100% chlorine at 140°F)





## Lead Free Crimp Fittings

RIIFO crimp fittings are used for making connections to PEX pipes. They are in compliance with the US Drinking Water Act and 2011 US Reduction of lead in Drinking Water by containing equal to or less than 0.25% lead. It is manufactured to comply with ASTM F1807 and F877.

### Advantages

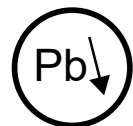

Hygienic and healthy, certified by NSF and free of lead.



High-quality copper material, and go through tensile, hardness and anti-corrosion tests.



Removable and reusable



Suitable for two kinds of clamp ring, convenient operation.



Safe and reliable with no O-ring aging problem.



Strict quality control



## Press Fittings

RIIFO press fitting is mainly available for potable water systems. It is used for making connections with PEX pipes.

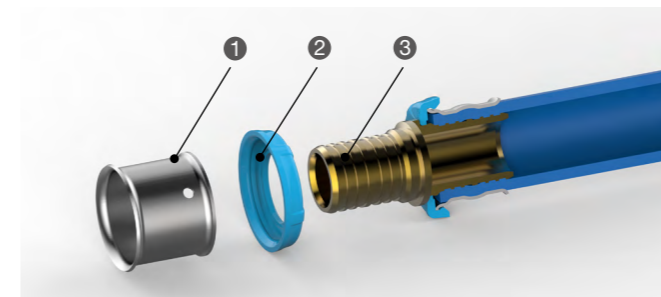

1 Press Ring  
2 Plastic Gasket  
3 Fitting Main Body

Material: SUS304  
Material: PE  
Material: Lead-free brass

### Advantages



Portholes directly show the positions of inserted pipes which can avoid leakage caused by installation errors.



Unique plastic gasket design for tool positioning.

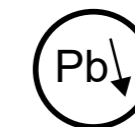

Hygienic and healthy, free of lead.



Safe and reliable with no O-ring aging problem.

# TECHNICAL DATA

- Pressure and Temperature
- 73.4° F at 160 psi
- 180° F at 100psi

## Standards

- ASTM F876/F877
- ASTM F1807
- CSA B137.5
- NSF 14
- NSF 61

## Certificates



# SPECIFICATIONS

## PEX Pipes

### PEX Pipe RIIFO



Model	Specif.	Packing Specif.(m)	Color
045286	1/2"	91.5m	White/Red/Blue
045270	3/4"	91.5 m	White/Red/Blue
045280	1"	91.5 m	White/Red/Blue

## Lead Free Crimp Fittings

### LF brass crimp couplings

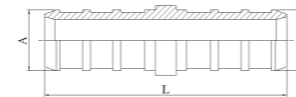

Model	Specif.	Packing Specif.(m)	A	B	L
045350	1/2" x 1/2"	1250	11.96	11.96	35
045351	3/4" x 3/4"	750	16.94	16.94	35
045352	1" x 1"	350	21.74	21.74	44

### LF brass crimp reducing couplings

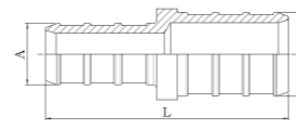

Model	Specif.	Packing Specif.(m)	A	B	L
011447A	3/4" x 1/2"	800	11.96	16.94	35
011448A	1 x 3/4"	500	16.94	21.74	39.5

### LF brass crimp male adapters

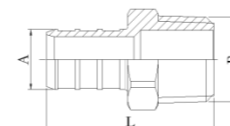

Model	Specif.	Packing Specif.(m)	A	B	L
045356	1/2"x1/2" NPT	625	11.96	NPT1/2	36
027392A	3/4"x1/2" NPT	500	16.94	NPT1/2	36
027393A	1/2"x3/4" NPT	375	11.96	NPT3/4	37
045359	3/4"x3/4" NPT	375	16.94	NPT3/4	37
027395A	3/4"x1" NPT	250	16.94	NPT1	39
011452A	1"x3/4" NPT	250	21.74	NPT3/4	41.5
045362	1" x 1" NPT	200	21.74	NPT1	43.5

LF brass crimp female adapters

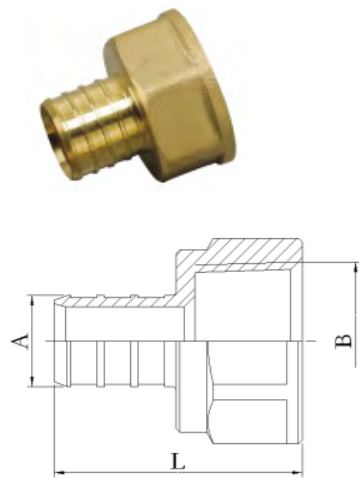

Model	Specif.	Packing Specif.(m)	A	B	L
045363	1/2"x1/2"NPT	500	11.96	NPT1/2	32.5
045364	3/4"x3/4"NPT	250	16.94	NPT3/4	34
045365	1" x 1" NPT	200	21.74	NPT1	39.5
029744A	1/2"x3/4"NPT	375	11.96	NPT3/4	34
029745A	3/4"x1/2"NPT	375	16.94	NPT1/2	32.5

LF brass crimp male sweat adapters

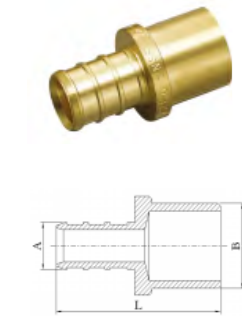

Model	Specif.	Packing Specif.(m)	A	B	L
027401A	1/2" x 1/2" Cu	1000	11.96	15.9	33.5
027402A	3/4" x 3/4" Cu	500	16.94	22.25	39.5
027403A	1" x 1" Cu	250	21.74	28.63	48.5
029749A	1/2" x 3/4" Cu	375	11.96	22.25	39.5
029750A	3/4" x 1/2" Cu	375	16.94	15.9	33.5

LF brass crimp female sweat adapters

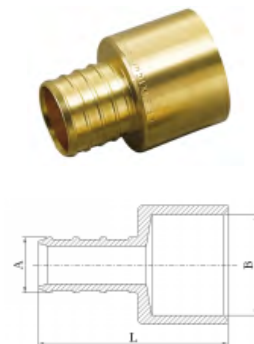

Model	Specif.	Packing Specif.(m)	A	B	L
027404A	1/2" x 1/2" CuF	1000	11.96	15.93	30.5
027405A	3/4" x 3/4" CuF	375	16.94	22.28	38
027406A	1" x 1" CuF	250	21.74	28.65	47
029752A	1/2" x 3/4" CuF	500	11.96	22.28	38
029753A	3/4" x 1/2" CuF	625	16.94	15.93	30.5

LF brass crimp elbows

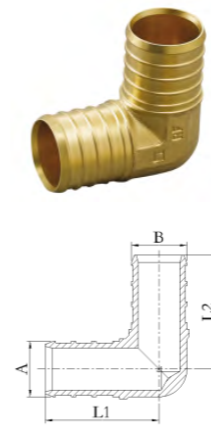

Model	Specif.	Packing Specif.(m)	A	B	L1	L2
045378	1/2" x 1/2"	850	11.96	11.96	24.5	24.5
045379	3/4" x 3/4"	375	16.94	16.94	27	27
045380	1" x 1"	200	21.74	21.74	34	34
027425A	3/4" x 1/2"	625	11.96	16.94	27	25

LF brass crimp male elbows

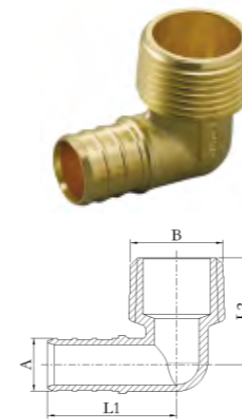

Model	Specif.	Packing Specif.(m)	A	B	L1	L2
045382	1/2" x 1/2"NPT	250	11.96	NPT1/2	29	24
045383	1/2 x 3/4" NPT	375	11.96	NPT3/4	31	27
045384	3/4" x 3/4"NPT	250	16.94	NPT3/4	31.5	28.5

LF brass crimp wall-plated elbows

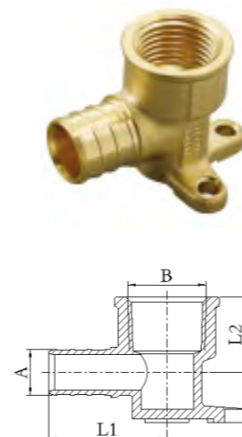

Model	Specif.	Packing Specif.(m)	A	B	L1	L2
045387	1/2"x1/2"NPT	200	11.96	NPT1/2	30.5	19.5
045388	3/4"x3/4"NPT	100	16.94	NPT3/4	33.5	24

LF brass crimp male sweat elbows

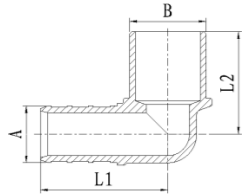

Model	Specif.	Packing Specif.(m)	A	B	L1	L2
029755A	1/2" x 1/2" Cu	750	11.96	15.9	26.5	21.5
029757A	3/4" x 3/4" Cu	250	16.94	22.25	30	30.5

LF brass crimp female sweat elbows

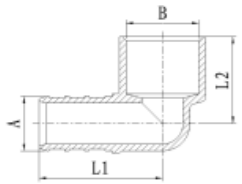

Model	Specif.	Packing Specif.(m)	A	B	L1	L2
029758A	1/2" x 1/2" CuF	750	11.96	15.93	27	19
029761A	3/4" x 3/4" CuF	250	16.94	22.28	30	27
029759A	1/2" x 3/4" CuF	375	11.96	22.28	30	25
029760A	3/4" x 1/2" CuF	500	16.94	15.93	27	22

LF brass crimp tees

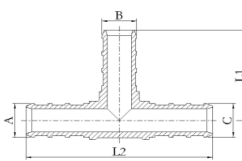

Model	Specif.	Packing Specif.(m)	A	B	C	L1	L2
045397	1/2" x 1/2" x 1/2"	600	11.96	11.96	11.96	24	48
045398	3/4" x 3/4" x 3/4"	250	16.94	16.94	16.94	27	54
045399	1" x 1" x 1"	150	21.74	21.74	21.74	34	68

LF brass crimp reducing tees

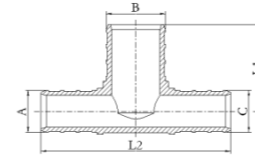

Model	Specif.	Packing Specif.(m)	A	B	C	L1	L2
027411A	1/2"x3/4"x1/2"	500	11.96	16.94	11.96	24.5	54
045401	3/4"x1/2"x1/2"	500	16.94	11.96	11.96	27	48.5
045402	3/4"x3/4"x1/2"	375	16.94	16.94	11.96	27	53.5
027414A	3/4"x1/2"x3/4"	375	16.94	11.96	16.94	27	49
027417A	1"x1/2"x1"	250	21.74	11.96	21.74	30	57
045408	1" x 1" x 1/2"	150	21.74	21.74	11.96	34	63.5
045405	1" x 1" x 3/4"	150	21.74	21.74	16.94	34	63.5
027418A	1"x3/4"x1"	150	21.74	16.94	21.74	30.5	63
007995A	3/4"x1"x3/4"	150	16.94	21.74	16.94	31.5	61
031046A	1"x3/4"x1/2"	200	21.74	16.94	11.96	29	58
045404	1"x3/4"x3/4"	200	21.74	16.94	16.94	29	57.5

LF brass crimp test plugs

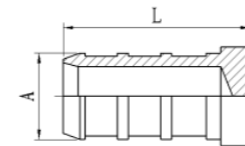

Model	Specif.	Packing Specif.(m)	A	B
045412	1/2"	1875	11.96	19
045413	3/4"	1250	16.94	19
045414	1"	500	21.74	23.5

Copper Clamp Ring PEX RIIFO

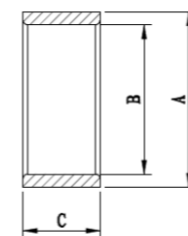

Model	Specif.	Packing Specif.(m)	A	B	C
048607	1/2"	2000	19.05	16.21	8.3
048608	3/4"	1200	25.4	22.56	8.3
048609	1"	500	31.8	29.32	9.27

Stainless steel Clamp PEX RIIFO

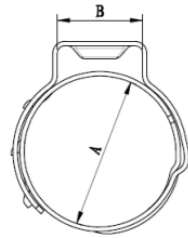

Model	Specif.	Packing Specif.(m)	A	B
048610	1/2"	1000	17.5	10
048611	3/4"	1000	23.3	10
048612	1"	500	29.6	10

203 Ball valve PEX RIIFO

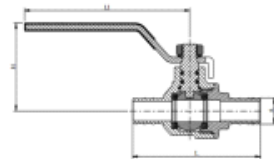

Model	Specif.	Packing Specif.(m)	A	H	L1	L
045240	1/2" X 1/2"	150	11.96	40	84	65
045241	3/4" X 3/4"	150	16.94	53.5	100.5	69.5
045242	1" X 1"	60	21.74	57	100.5	84.5

Press Fittings

Test plug

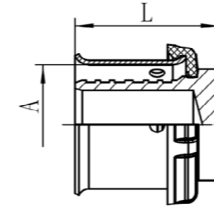
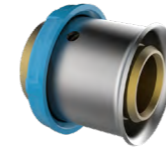

Model	Specif.	Packing Specif.(m)	A	L
042248	1/2"	960	16.1	19.5
045331	3/4"	500	22.5	19.5
045332	1"	400	28.8	23.5

Coupling

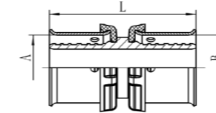

Model	Specif.	Packing Specif.(m)	A	B	L
042234	1/2"	480	16.1	16.1	36
045288	3/4"	300	22.5	22.5	36
045289	1"	200	28.8	28.8	44.3

Reducing coupling

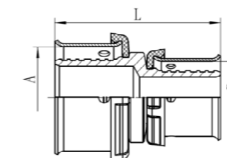

Model	Specif.	Packing Specif.(m)	A	B	L
045290	3/4" x 1/2"	250	22.5	16.1	40.7
045291	1" x 3/4"	200	28.8	22.5	36.7

Male adapter

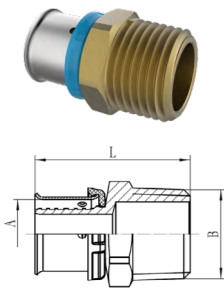

Model	Specif.	Packing Specif.(m)	A	H	L1
042232	1/2" x1/2" NPT	400	16.1	NPT 1/2	37
045295	1/2" x3/4" NPT	300	16.1	NPT 3/4	38.5
045297	3/4" x1/2" NPT	300	22.5	NPT 1/2	37
045293	3/4" x3/4" NPT	300	22.5	NPT 3/4	38
045298	3/4" x1" NPT	160	22.5	NPT 1	40.5
045296	1" x3/4" NPT	200	28.8	NPT 3/4	42.5
045294	1" x1" NPT	160	28.8	NPT 1	44.5

Female adapter

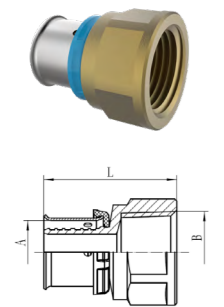

Model	Specif.	Packing Specif.(m)	A	B	L
042233	1/2" x1/2" NPT	400	16.1	NPT 1/2	33.5
045302	1/2" x3/4" NPT	240	16.1	NPT 3/4	35.5
045304	3/4" x1/2" NPT	400	22.5	NPT 1/2	33
045300	3/4" x3/4" NPT	240	22.5	NPT 3/4	35
045303	1" x3/4" NPT	200	28.8	NPT 3/4	38.5
045301	1" x1" NPT	120	28.8	NPT 1	40.5

Reducing elbow

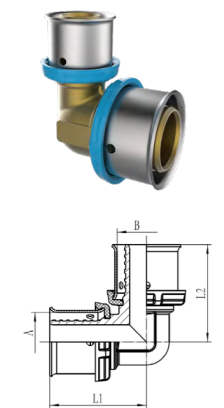

Model	Specif.	Packing Specif.(m)	A	B	L1	L2
042246	1/2"	300	16.1	16.1	27	27
045306	3/4"	200	22.5	22.5	30	30
045307	1"	120	28.8	28.8	37.5	37.5

Male elbow

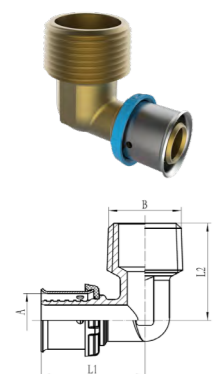

Model	Specif.	Packing Specif.(m)	A	B	L1	L2
045308	1/2" x1/2" NPT	300	16.1	NPT 1/2	29.5	27
045311	1/2" x3/4" NPT	240	16.1	NPT 3/4	32.5	28
045309	3/4" x3/4" NPT	160	22.5	NPT 3/4	32.5	33.5
045312	3/4" x1" NPT	120	22.5	NPT 1	36.5	33.5
045310	1" x1" NPT	120	28.8	NPT 1	40.5	36.5

Tee

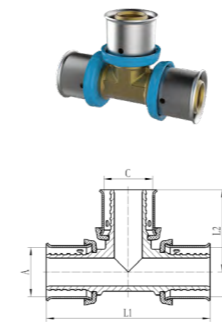

Model	Specif.	Packing Specif.(m)	A	B	C	L1	L2
042245	1/2"	210	16.1	16.1	16.1	54	27
045317	3/4"	100	22.5	22.5	22.5	60	30
045318	1"	80	28.8	28.8	28.8	75	37.5

Reducing tee

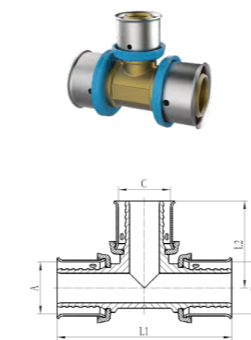

Model	Specif.	Packing Specif.(m)	A	C	B	L1	L2
045319	1/2" x1/2" x3/4"	200	16.1	22.5	16.1	60	27
045327	3/4" x1/2" x1/2"	200	22.5	16.1	16.1	53.5	30
045329	3/4" x1/2" x3/4"	150	22.5	22.5	16.1	60	30
045328	3/4" x3/4" x1/2"	150	22.5	16.1	22.5	54	30
045321	1" x1/2" x1/2"	120	28.8	16.1	16.1	58	33.5
045323	1" x1/2" x1"	80	28.8	28.8	16.1	71	37.5
045322	1" x3/4" x1/2"	50	28.8	16.1	22.5	58	33.5
045326	1" x3/4" x3/4"	80	28.8	22.5	22.5	64	33.5
045324	1" x3/4" x1"	80	28.8	28.8	22.5	71	37.5
045320	1" x1" x1/2"	80	28.8	16.1	28.8	62	33.5
045325	1" x1" x3/4"	80	28.8	22.5	28.8	68	33.5

Drop Ear 90° elbow

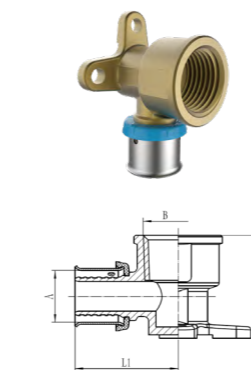

Model	Specif.	Packing Specif.(m)	A	B	L1	L2
042247	1/2" x1/2" NPT	160	16.1	NPT 1/2	31.5	32.5
045314	3/4" x1/2" NPT	120	22.5	NPT 1/2	31.5	38
045315	3/4" x3/4" NPT	120	22.5	NPT 3/4	34	40.5

## Manifolds

### Brass linear manifolds-FS3

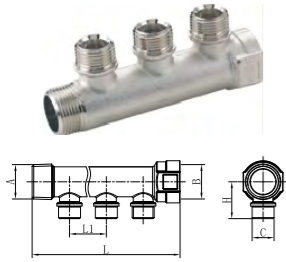

Model	Specif.	Packing Specif.(m)	A	B	C	H	L1
014208A	3/4" x 1/2"- 2	108	NPT3/4	NPT3/4	G1/2	35	35
014209A	3/4" x 1/2"- 3	72	NPT3/4	NPT3/4	G1/2	35	35
014210A	3/4" x 1/2"-4	48	NPT3/4	NPT3/4	G1/2	35	35
014211A	1" x 1/2"- 2	90	NPT1	NPT1	G1/2	35	35
014212A	1" x 1/2"- 3	60	NPT1	NPT1	G1/2	35	35
014213A	1" x 1/2"- 4	48	NPT1	NPT1	G1/2	35	35

### Brass manifolds with stop valves-FS4

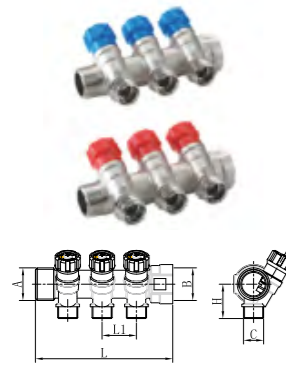

Model	Specif.	Packing Specif.(m)	A	B	C	H	L1
039988A	3/4" x 1/2"- 2	60	R3/4	G3/4	G1/2	35	35
039987A	3/4" x 1/2"- 2	60	R3/4	G3/4	G1/2	35	35
014149A	3/4" x 1/2"- 3	48	R3/4	G3/4	G1/2	35	35
014152A	3/4" x 1/2"- 3	48	R3/4	G3/4	G1/2	35	35
014150A	3/4" x 1/2"- 4	30	R3/4	G3/4	G1/2	35	35
014153A	3/4" x 1/2"- 4	30	R3/4	G3/4	G1/2	35	35

### Brass manifolds with ball valves-FS5

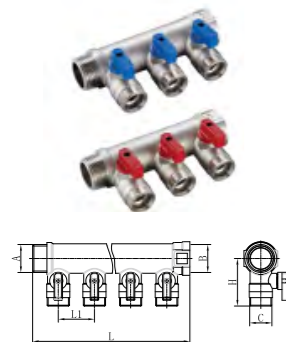

Model	Specif.	Packing Specif.(m)	A	B	C	H	L1
044376	3/4"x1/2"-3	48	R3/4	G3/4	G1/2	49	36
044375	3/4"x1/2"-3	48	R3/4	G3/4	G1/2	49	36
044378	3/4"x1/2"-4	30	R3/4	G3/4	G1/2	49	36
044377	3/4"x1/2"-4	30	R3/4	G3/4	G1/2	49	36

## Tools & Accessories

### Connector core

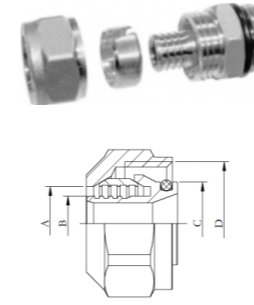

Model	Specif.	Packing Specif.(m)	A	B	C	D
004193A	1/2" x 1/2"	576	16.1	11.96	14.5	G1/2

### PEX crimp tool for copper crimp ring



Model	Specif.	Packing Specif.(m)
026873A	RIIFO HAND PRESS CLAMP-COPPER RING SYQ2-3/8-1	5

### PEX crimp tool for Stainless steel crimp



Model	Specif.	Packing Specif.(m)
018277A	RIIFO HAND PRESS CLAMP-STAINLESS STEEL CLAMP SYQ5-3/8-1	20

### PEX press tool



Model	Specif.	Packing Specif.(m)
039580A	PEX press tool SYQ7-3/8-1	1



# INSTALLATION

## PEX+Lead Free Crimp Fittings (Copper crimp ring)



**Step 1: Pipe cutting**  
Cut the pipe vertically by RIIFO pipe cutter. Make sure to cut it quickly and precisely.



**Step 2: Sleeving**  
Choose the right size fitting according to the pipe. Put the copper crimp ring over the pipe at the right position.



Later, insert the fitting body into the pex pipe until the shoulder of the fitting reach the pex pipe, make sure the insert is completely inside the pipe, and the contact between fitting and pipe is clean and free of impurity.



**Step 3: Selecting the jaw**  
Choose the right size of fitting and jaw of the crimping tool.



**Step 4: Pressing**  
Open the crimping tool and put the fitting into the jaw. Press the jaw until it closes completely. While pressing, make sure the crimping jaw is vertical to the pipe, the pressing contact must be free of impurity.



**Step 5: Checking**  
Use the GO-NO-GO gauge to check whether the pressing is completed. If the crimp ring slides into the "GO" slot, but stops at the shoulder in the "GO" slot, then the pressing is acceptable.



## PEX+Lead Free Crimp Fittings (Stainless steel crimp)



### Step 1: Pipe cutting

Cut the pipe vertically by RIIFO pipe cutter. Make sure to cut it quickly and precisely.



### Step 2: Sleeving

Choose a right size of a stainless steel crimp and put it over the pipe slightly bigger than the pipe on size, slightly bigger than the pipe on size.



### Step 3: Inserting

Push the insert into the pipe up to the shoulder, make sure the insert is completely inside the pipe, and the contact between fitting and pipe is clean and free of impurity.



### Step 4: Pressing

Use the manual pressing tool with right size of jaw. Open the crimping tool and attach to the mouth of the crimp. Press the jaw until it closes completely. While pressing, make sure the crimping jaw is vertical to the pipe. The pressing contact must be clean and free of impurity.



Crimp will be tightened after pressing and pipe will be tightly linked to the fitting.

## PEX+Press Fitting



### Step 1: Pipe cutting

Cut the pipe vertically and precisely with a RIIFO pipe cutter.



### Step 2: Inserting

Choose the right size Press-fitting for the pipe, then aim the pipe end at the inspection holes of corresponding fitting and slide the fitting insert into the pipe until it reaches the bottom.



### Step 3: Pressing

Insure the sleeve at the right position in the jaw; The margin of the sleeve must be placed into the groove of the pressing section.



### Step 4: Verification

If pressed correctly, the joint will fit the "GO" side of the corresponding size of the gauge.